

NAMES AND FUNCTIONS OF REMOTE CONTROLLER

REMOTE CONTROLLER

- This controls the operation of the indoor unit. The range of control is about 7 meters. If indoor lighting is controlled electronically, the range of control may be shorter.
This unit can be fixed on a wall using the fixture provided. Before fixing it, make sure the indoor unit can be controlled from the remote controller.
- Handle the remote controller with care. Dropping it or getting it wet may compromise its signal transmission capability.
- After new batteries are inserted into the remote controller, the unit will initially require approximately 10 seconds to respond to commands and operate.
- When remote controller is not in use for about 3 minutes during OFF condition, indicated by **OFF** on the display, the LCD will turn off.
- During clock setting, the LCD will turn off about 10 minutes later if the remote controller is not in use.
- When pressing any button, the LCD will turn on.
- The LCD will not turn off during TIMER setting.

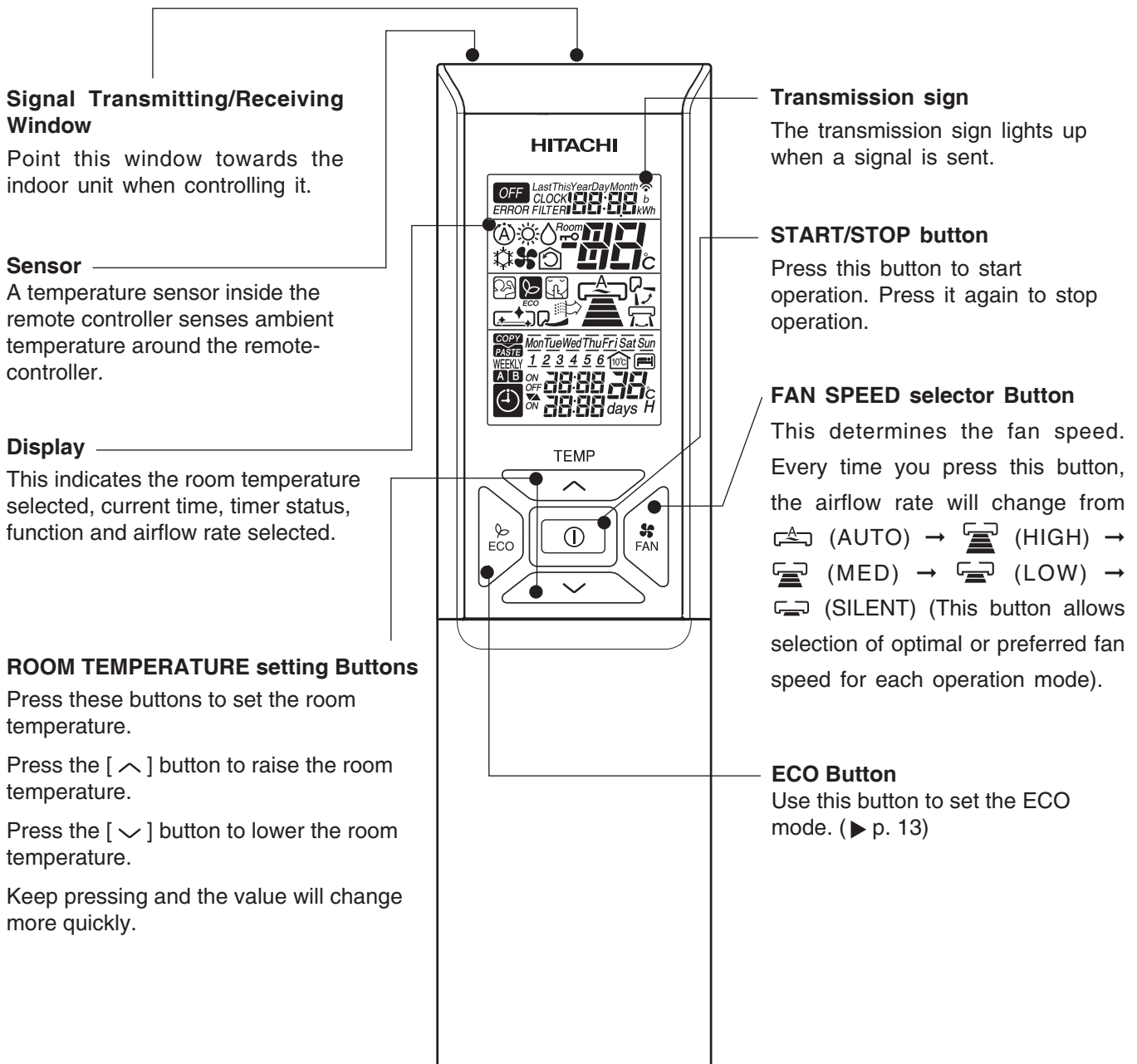

NAMES AND FUNCTIONS OF REMOTE CONTROLLER

POWERFUL Button
Use this button to set the POWERFUL mode. (▶ p. 11)

INFORMATION Button
(▶ p. 26)

ONE TOUCH CLEAN Button
(▶ p. 16)

LEAVE HOME Button
(▶ p. 15)

ECO SLEEP TIMER Button
Use this button to set the ECO sleep timer. (▶ p. 18)

ON / OFF TIMER setting Buttons
(▶ p. 17)

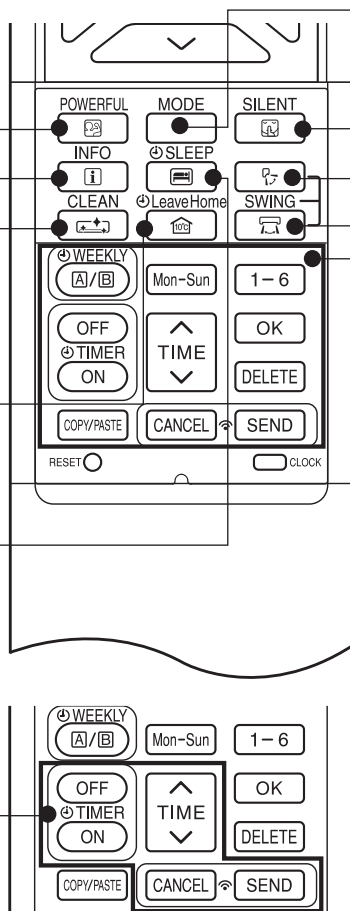

MODE selector Button
Use this button to select the operating mode. Every time you press this button, the mode will change from (A) (AUTO) → (☀) (HEAT) → (💧) (DEHUMIDIFY) → (❄️) (COOL) and → (🌀) (FAN) cyclically.

SILENT Button
Use this button to set the SILENT mode. (▶ p. 12)

AUTO SWING (Vertical) Button
Controls the angle of the horizontal air deflector. (▶ p. 10)

AUTO SWING (Horizontal) Button
Controls the angle of the vertical air deflector. (▶ p. 10)

WEEKLY TIMER setting Buttons
(▶ p. 20)

MODE	MODE SELECTOR
(A)	AUTO
(☀)	HEAT
(💧)	DEHUMIDIFY
(❄️)	COOL
(🌀)	FAN
(A)	FAN SPEED
(A)	AUTO
(A)	SILENT
(A)	LOW
(A)	MED
(A)	HIGH
(i)	START / STOP
(ECO)	ECO

(🌀)	FAN
(🔥)	POWERFUL
(🔇)	SILENT
(i)	INFO
(🛌)	SLEEP TIMER
(🔄)	AUTO SWING (VERTICAL)
(🔄)	AUTO SWING (HORIZONTAL)
(10°C)	LEAVE HOME
(↔️)	CLEAN
Mon-Sun	DAY
1-6	PROGRAM NO.

(OFF)	ON / OFF TIMER
(TIMER ON)	ON / OFF TIMER
(TIME)	TIME
(OK)	OK
(DELETE)	DELETE
(COPY/PASTE)	COPY / PASTE
(CANCEL)	CANCEL
(SEND)	SEND
(CLOCK)	CLOCK

Precautions for Use

- Do not put the remote controller in the following places.
 - Under direct sunlight.
 - In the vicinity of a heater.
- Handle the remote controller carefully. Do not drop it on the floor, and protect it from water.
- Once the outdoor unit stops, it will not restart for about 3 minutes (unless you turn the power switch off and on or unplug the power cord and plug it in again). This is to protect the device and does not indicate a failure.
- If you press the MODE selector button during operation, the device may stop for about 3 minutes for protection.